

Measure RR Safe Routes to BART Cycle 3 Project Fact Sheet

Union City's Pedestrian At-Grade Railroad Crossing

SR2B award (total project cost): \$3 million (\$11.5 million)

Project location: The east side of the Union City BART station (East Plaza and Transit Loop road)

Project components: This project improves walking and biking by installing an at-grade railroad crossing directly to the east side of the BART station. Due to active freight rail activity, the project will install:

- Concrete panels
- Warning devices
- Safety gates

The existing, at-grade railroad crossing of "I" Street near 12th Street, located about 0.4 miles north of the BART station, will be closed as a condition of approval from Union Pacific Railroad for implementing this project.

SR2B funding: Funds a portion of all elements of the project.

Distance from station: Directly adjacent to the Union City BART station.

Construction start (duration)*: Spring 2026 (1 year)

Project Location & Elements

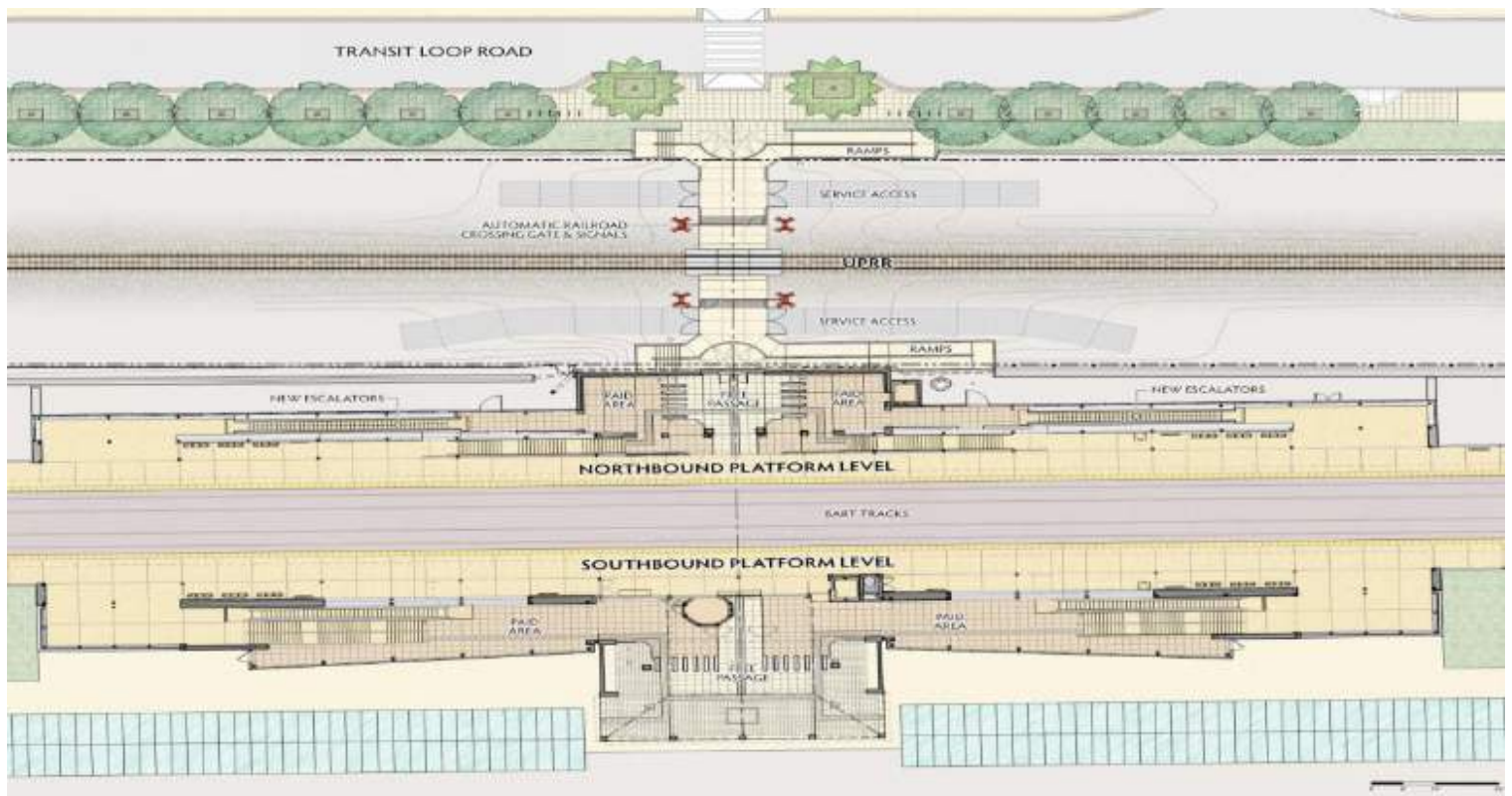



* Construction timelines subject to change

Published May 2026

Measure RR Safe Routes to BART Cycle 3 Project Fact Sheet

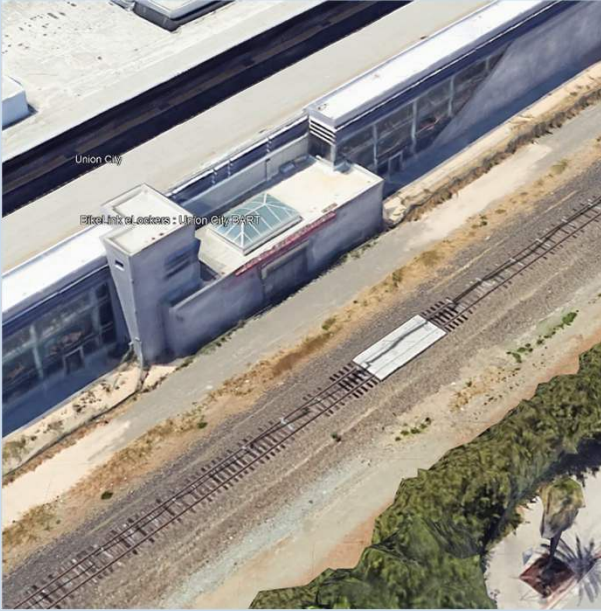
Union City's Pedestrian At-Grade Railroad Crossing

Location	Before	In Construction
<p>East of the BART station</p>	 <p>An aerial photograph showing the Union City station building and the adjacent railroad tracks. The area is mostly flat with some vegetation and a road running parallel to the tracks.</p>	 <p>Two photographs showing the construction progress. The top photo shows a concrete pump truck pouring concrete into a foundation for a structure, with the station building visible in the background. The bottom photo shows a large concrete pump truck positioned over a deep excavation pit, with the station building in the background.</p>
<p>"I" St near 12th St railroad crossing</p>	 <p>A street-level photograph of the railroad crossing at 'I' St near 12th St. The crossing is active, with cars visible on the street and railroad tracks crossing the road. A sign on the right side of the street reads 'DO NOT STOP ON TRACKS'.</p>	<p><i>Coming after construction</i></p>