



Passenger Bulletin

News of Special Interest to Our Passengers

Bay Area Rapid
Transit
300 Lakeside Dr.
Oakland, CA 94612
(510) 464-6000
www.bart.gov

EARTHQUAKE SAFETY CONSTRUCTION CONTINUES INSIDE CONCOURSE AT FRUITVALE

Dear Customers:

As part of BART's systemwide Earthquake Safety Program, seismic retrofit work at the Fruitvale Station continues. **STAGE TWO (2) earthquake safety construction inside the Fruitvale Station concourse is active with detours to escalators, stairs, and elevators. As early as Tuesday, November 27, direct access to Add Fare and Parking Payment machines will be restored. Please see diagram on back page for details.** Construction activity in the Concourse will continue for a couple more months. Please plan for additional time to travel inside the station from the concourse to the platform. Parking machines, escalators, stairs, elevators, and restrooms will remain accessible during construction. Construction crews have enclosed work areas, and you will see construction equipment accessing the site such as scissor lifts, drill rigs, concrete pump/hose and trucks, and scaffolding. This is work on each footing and pier cap (a beam connecting two columns), which supports the BART track. During this construction, ADA/pedestrian access/pathway will be detoured with directional signs. Please proceed around construction areas with caution and watch for signs with safety information and other notices. Please be advised that changes/modifications maybe required at any time; the construction team will make every effort to minimize inconveniences. Additionally, periodic nighttime work for material delivery and light work activity may be needed and will be monitored for noise levels.

At the same time, work continues outside Fruitvale Station on both sides of 35th Avenue, and outside the main entrance near Avenida de la Fuente. Expect some traffic and parking impacts during this work. Temporary closure of approximately six (6) parking spots in the BART Fee lot (south of 35th Avenue) will remain in effect. Please note that vehicles not moved from areas that have been posted with "No Parking" signs will be subject to ticketing and/or towing. Noise, dust, and odors will be monitored, and local regulations will be enforced to minimize any inconveniences. Please watch for additional notices regarding upcoming construction.

We appreciate your patience and cooperation during this work. As always, safety is BART's top priority. Our aim is to complete seismic retrofit work as quickly as possible, while maintaining BART service. **Fruitvale Station will REMAIN OPEN for BART riders during construction.**

To contact the Earthquake Safety Program or obtain additional information, please visit our website at **www.bart.gov/earthquakesafety** or call our Program Information Line at **(510) 874-7425**. Thank you again for your patience and cooperation.

If you need language assistance services, please call BART's Transit Information Center at (510) 465-2278.

Si necesita servicios de asistencia de idioma, llame al centro de información de tránsito del BART al (510) 465-2278.

如需語言援助服務，請致電 BART 公共交通資訊中心，電話號碼為 (510) 465-2278.

통역이 필요하시면, BART 수송 정보 센터 (510) 465-2278 로 전화해 주십시오.

Nếu quý vị cần các dịch vụ trợ giúp ngôn ngữ, xin gọi cho Trung Tâm Thông Tin Chuyên Chở Công Cộng của BART tại số (510) 465-2278.

Kung kailangan mo ang tulong ng mga serbisyo ng wika, paki tawagan ang BART Transit Information Center na (510) 465-2278

EARTHQUAKE SAFETY CONSTRUCTION ACTIVITY LOCATIONS

Stage 1 Construction inside FRUITVALE STATION, Phase B

CONCOURSE

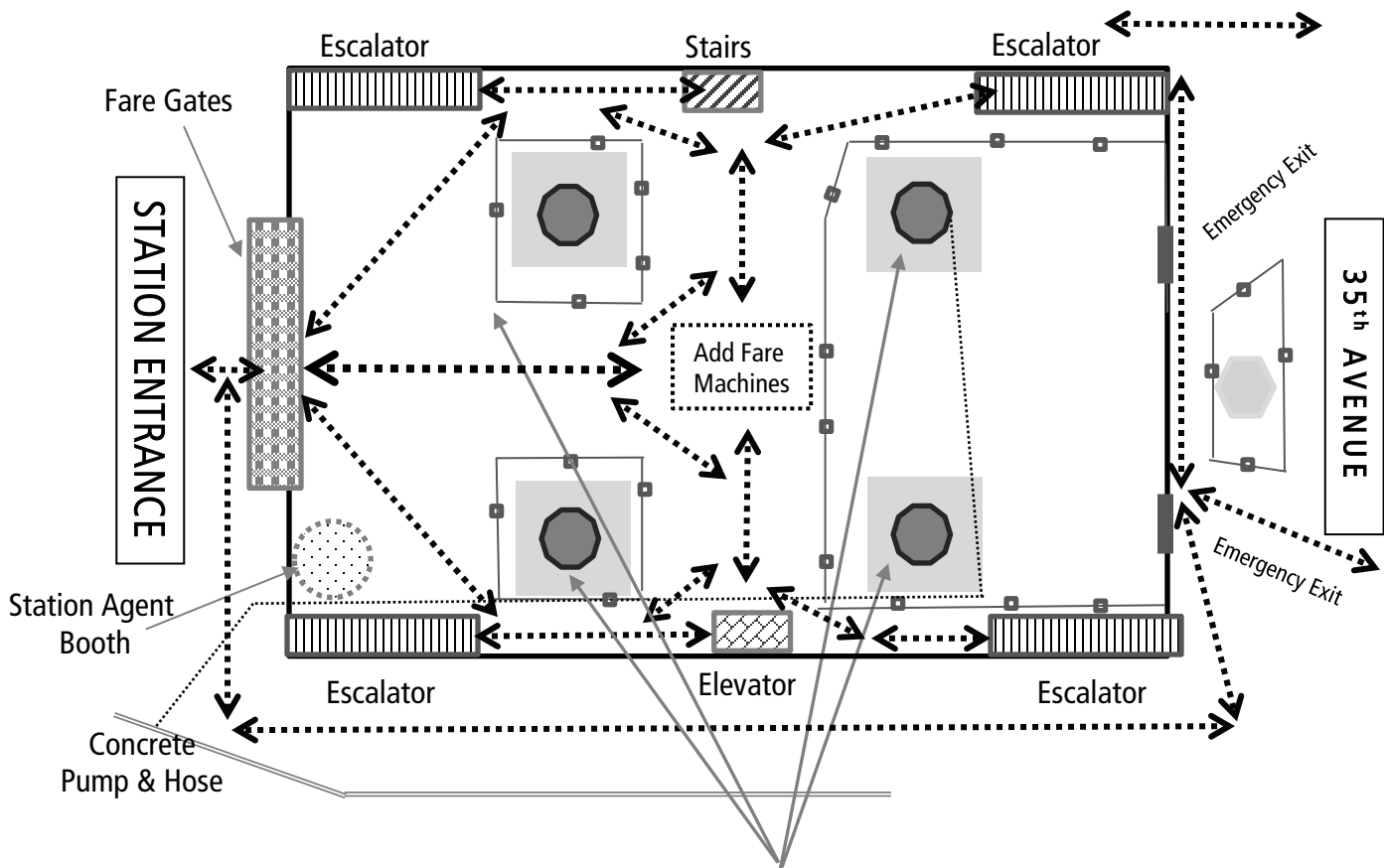

*****THANK YOU FOR YOUR PATIENCE AND COOPERATION DURING CONSTRUCTION*****
 Construction Work Locations at Fruitvale Station (Column and pier cap structures located inside the concourse. Stage 2, direct access to add fare machines restored and construction activity inside the concourse continues.) – **In Progress**

Legend:

- Temporary enclosure
- ADA/Pedestrian path
- Concrete pump & hose

Note: During Construction, all stairs, elevators, escalators, utility rooms and restrooms are expected to remain open and accessible. Only one emergency exit (of the two) will remain accessible during construction.