



# Earthquake Safety Program

## Notification

### Temporary Changes to Parking At Rockridge Station

November 2008

Dear BART Patron:

As part of our system-wide Earthquake Safety Program, we will begin strengthening structures at the Rockridge Station to withstand future earthquakes. The work requires temporary relocation of some **reserved permit** parking spaces, but the number of monthly reserved permit spaces will not be reduced. Relocated permit spaces will temporarily replace adjacent daily fee parking spaces. The total number of **daily fee** parking spaces will be reduced to make space for the work. Please watch for relocation signs and other information.

Work will occur in four stages, beginning early December in the western permit parking area. The diagram below shows the approximate location of each stage. To reduce the effect of the loss of spaces in Stage 4, attended parking will be provided. Stage 4 will likely begin mid 2009. Attendants will issue tickets to ensure safe return of your vehicle, and normal BART fees and validation will remain in effect. Attendants will be in uniform and present during Stage 4 between 6:00 AM and 10:00 PM, Monday through Friday. We appreciate your patience and cooperation during this work and will attempt to minimize construction-related noise, dust and inconvenience.

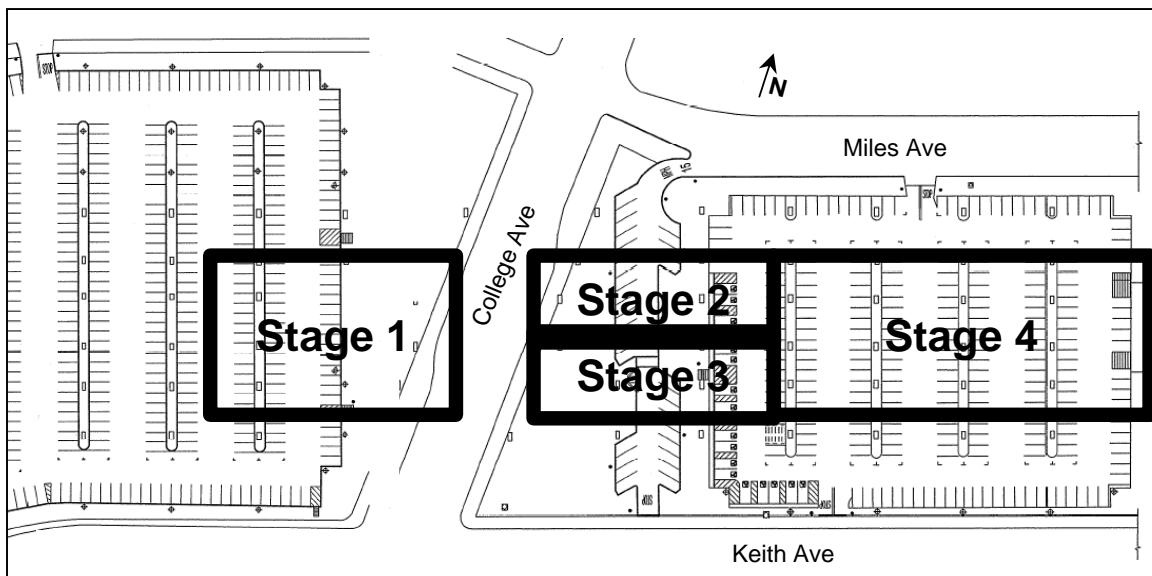

A related project to strengthen columns over the remainder of the western parking lot and nearby streets will occur in the future. Earthquake Safety Program construction will be underway at

various locations throughout the BART system over the next five years, and is expected to be complete by the end of 2013. As always, safety is BART's top priority. Our aim is to strengthen BART as quickly as possible, while maintaining BART service.

To contact the Earthquake Safety Program or obtain additional information, please visit our website at [www.bart.gov/earthquakesafety](http://www.bart.gov/earthquakesafety) or call our Program Information Line at **510.874.7425**. Thank you again for your patience and cooperation.

Si necesita información en español, por favor llame al 510.874.7425.

## **ABOUT THE PROGRAM**

The BART Earthquake Safety Program will upgrade the original BART system to ensure safety and the ability to return to operation shortly after a major earthquake.

Priorities for strengthening work include BART's Transbay Tube, elevated structures and many stations.

Thank you for supporting BART's efforts to protect this Bay Area asset.